

Carbon Chain Turnbuckles

Turnbuckles CM伸縮器



Prodct						
Eye & Eye	Jaw & Eye	Jaw & Jaw	Thread Diameter	Take Up	WLL	Weight Each
			in.	in.	lbs.	in.
0404EE	0404JE	0404JJ	1/4	4	500	0.4
0504EE	0504JE	0504JJ	5/16	4-1/2	800	0.6
0606EE	0606JE	0606JJ	3/8	6	1,200	0.9
0806EE	0806JE	0806JJ	1/2	6	2,200	1.8
0809EE	0809JE	0809JJ	1/2	9	2,200	2.1
0812EE	0812JE	0812JJ	1/2	12	2,200	2.4
1006EE	1006JE	1006JJ	5/8	6	3,500	3.0
1009EE	1009JE	1009JJ	5/8	9	3,500	3.7
1012EE	1012JE	1012JJ	5/8	12	3,500	4.2
1206EE	1206JE	1206JJ	3/4	6	5,200	4.6
1209EE	1209JE	1209JJ	3/4	9	5,200	5.4
1212EE	1212JE	1212JJ	3/4	12	5,200	6.0
1218EE	1218JE	1218JJ	3/4	18	5,200	7.7
1412EE	1412JE	1412JJ	7/8	12	7,200	8.4
1418EE	1418JE	1418JJ	7/8	18	7,200	10.7
1606EE	1606JE	1606JJ	1	6	10,000	9.7
1612EE	1612JE	1612JJ	1	12	10,000	11.9
1618EE	1618JE	1618JJ	1	18	10,000	14.8
1624EE	1624JE	1624JJ	1	24	10,000	18.2
2012EE	-	2012JJ	1-1/4	12	15,200	23.8
2018EE	-	2018JJ	1-1/4	18	15,200	27.5
2024EE	-	2024JJ	1-1/4	24	15,200	33.7
2412EE	-	2412JJ	1-1/2	12	21,400	38.1
2418EE	-	2418JJ	1-1/2	18	21,400	44.2
2424EE	-	2424JJ	1-1/2	24	21,400	48.4

Prodct						
Hook & Eye	Hook & Hook	Thread Diameter	Take Up	WLL	Weight Each	
		in.	in.	lbs.	in.	
0404HE	0404HH	1/4	4	400	-	
0504HE	0504HH	5/16	4.5	700	-	
0606HE	0606HH	3/8	6	1,000	0.8	
0806HE	0806HH	1/2	6	1,500	1.5	
0809HE	0809HH	1/2	9	1,500	1.9	
0812HE	0812HH	1/2	12	1,500	2.3	
1006HE	1006HH	5/8	6	2,250	2.5	
1009HE	1009HH	5/8	9	2,250	3.3	
1012HE	1012HH	5/8	12	2,250	3.8	
1206HE	1206HH	3/4	6	3,000	3.9	
1209HE	1209HH	3/4	9	3,000	4.8	
1212HE	1212HH	3/4	12	3,000	5.4	
1218HE	1218HH	3/4	18	3,000	7	
1412HE	1412HH	7/8	12	4,000	7.4	
1418HE	1418HH	7/8	18	4,000	9.6	
1606HE	1606HH	1	6	5,000	9	
1612HE	1612HH	1	12	5,000	11.2	
1618HE	1618HH	1	18	5,000	13.8	
1624HE	1624HH	1	24	5,000	17.1	
2418HE	2418HH	1 1/2	18	7,500	31.2	
2424HE	2424HH	1 1/2	24	7,500	38.2	

Crosby® Turnbuckles 伸縮器



**HG-223
Hook & Hook**
Meets the performance requirements of Federal Specifications FF-T-791b, Type 1, Form 1 - Class 5, and ASTM F-1145, except for those provisions required of the contractor.



**HG-225
Hook & Eye**
Meets the performance requirements of Federal Specifications FF-T-791b, Type 1, Form 1 - Class 5, and ASTM F-1145, except for those provisions required of the contractor.



**HG - 226
Eye & Eye**
Meets the performance requirements of Federal Specifications FF-T-791b, Type 1, Form 1 - Class 5, and ASTM F-1145, except for those provisions required of the contractor.



**HG - 227
Jaw & Eye**
Meets the performance requirements of Federal Specifications FF-T-791b, Type 1, Form 1 - Class 5, and ASTM F-1145, except for those provisions required of the contractor.



**HG-228
Jaw & Jaw**
Meets the performance requirements of Federal Specifications FF-T-791b, Type 1, Form 1 - Class 5, and ASTM F-1145, except for those provisions required of the contractor.

- Turnbuckle assembly combinations include: Eye and Eye, Hook and Hook, Hook and Eye, Jaw and Jaw & Jaw and Eye.
- End fittings are Quenched and Tempered, bodies heat treated by normalizing.
- Crosby's Quenched and Tempered end fittings and normalized bodies have enhanced impact properties for greater toughness at all temperatures.
- Hot Dip galvanized.
- Hooks are forged with a greater cross sectional area that results in a stronger hook with better fatigue properties.
- Modified UNJ thread on end fittings for improved fatigue properties. Body has UNC threads.
- Turnbuckle eyes are forged elongated, by design, to maximize easy attachment in system and minimize stress in the eye. For turnbuckle sizes 1/4" through 2-1/2", a shackle one size smaller can be reeved through eye.
- Forged jaw ends are fitted with bolts and nuts on sizes 1/4" - 5/8", and pins and cotter on sizes 3/4" - 2-3/4".
- **TURNBUCKLES RECOMMENDED FOR STRAIGHT OR IN-LINE PULL ONLY.**
- Lock Nuts available for all sizes.
- Typical hardness levels, Tensile Strengths and Ductility Properties are available for all sizes.
- Turnbuckles can be furnished proof tested or magnaflux inspected with certificates if requested at time of order.
- Crosby products meet or exceed all the requirements of ASME B30.26 including identification, ductility, design factor, proof load and temperature requirements. Importantly, Crosby products meet other critical performance requirements including fatigue life, impact properties and material traceability, not addressed by ASME B30.26.



Modified thread:
Note stress relieving radii in this unretouched photo enlargement of the supabuckle.



Standard thread:
Note stress building sharp "V" in this untouched photo enlargement.

鉤對鉤伸縮器

Hook & Hook Turnbuckles

HG-223



Meets the performance requirements of Federal Specifications FF-T-791b, Type 1 Form 1 - CLASS 5, and ASTM F-1145, except for those provisions required of the contractor. For additional information, see page 391.

- End fittings are Quenched and Tempered, bodies heat treated by normalizing.
- Hot Dip galvanized steel.
- Hooks are forged with a greater cross sectional area that results in a stronger hook with better fatigue properties.
- Crosby products meet or exceed all requirements of ASME B30.26 including identification, ductility, design factor, proof load and temperature requirements. Importantly, Crosby products meet other critical performance requirements including fatigue life, impact properties and material traceability, not addressed by ASME B30.26.
- TURNBUCKLES RECOMMENDED FOR STRAIGHT OR IN-LINE PULL ONLY.
- Modified UNJ thread on end fittings for improved fatigue properties.
- Body has UNC threads.
- Lock Nuts available for all sizes (see page 170).
- Comprehensive end fitting data provided on page 166.
- Fatigue Rated.

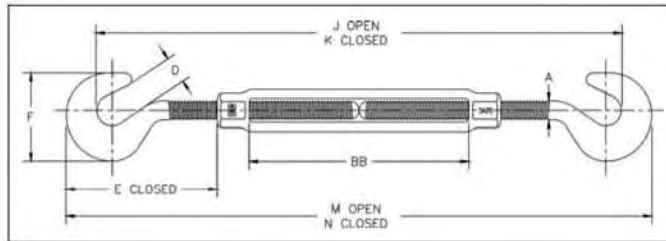

HG-223 Hook & Hook

Thread Dia. & Take Up (in.)	HG-223 Stock No.	Working Load Limit (lbs.)*	Weight Each (lbs.)	Dimensions (in.)								
				A	D	E Closed	F	J Open	K Closed	M Open	N Closed	BB
† 1/4 x 4	1030011	400	.33	.25	.44	1.67	1.27	9.79	7.38	12.20	8.20	4.07
† 5/16 x 4-1/2	1030039	700	.52	.31	.50	2.00	1.50	11.58	8.58	14.08	9.58	4.58
† 3/8 x 6	1030057	1000	.83	.38	.56	2.28	1.77	15.23	10.62	17.84	11.84	6.10
1/2 x 6	1030075	1500	1.88	.50	.65	3.53	2.28	17.98	13.20	20.76	14.76	6.03
1/2 x 12	1030119	1500	2.77	.50	.65	3.51	2.28	30.27	19.49	33.05	21.05	12.36
5/8 x 6	1030137	2250	3.21	.63	.90	4.24	2.81	19.50	14.50	22.50	16.50	6.03
5/8 x 12	1030173	2250	4.58	.63	.90	4.23	2.81	31.84	20.84	34.84	22.84	12.39
3/4 x 6	1030191	3000	4.20	.75	.98	5.07	3.33	21.19	15.98	24.40	18.40	6.13
3/4 x 12	1030235	3000	6.92	.75	.98	5.04	3.33	33.59	22.38	36.80	24.80	12.59
3/4 x 18	1030253	3000	8.65	.75	.98	5.07	3.33	45.59	28.38	48.80	30.80	18.53
7/8 x 12	1030271	4000	9.85	.88	1.13	5.82	3.78	34.89	23.52	38.26	26.26	12.16
1 x 12	1030333	5000	14.8	1.00	1.25	6.56	4.25	36.59	25.06	40.12	28.12	12.18

* Proof Load is 2.5 times the Working Load Limit. Ultimate Load is 5 times the Working Load Limit.

† Mechanical Galvanized

鉤對眼伸縮器

Hook & Eye Turnbuckles

HG-225



Meets the performance requirements of Federal Specifications FF-T-791b, Type 1, Form 1 — CLASS 6, and ASTM F-1145, except for those provisions required of the contractor. For additional information, see page 391.

HG-225 Hook & Eye

- End fittings are Quenched and Tempered, bodies heat treated by normalizing.
- Hot Dip galvanized steel.
- Turnbuckle eyes are forged elongated, by design, to maximize easy attachment in system and minimize stress in the eye. For turnbuckles sizes 1/4" through 1", a shackle one size smaller can be reeved through eye.
- Turnbuckle hooks are forged with a greater cross sectional area that results in a stronger hook with better fatigue properties.
- Crosby products meet or exceed all requirements of ASME B30.26 including identification, ductility, design factor, proof load and temperature requirements. Importantly, Crosby products meet other critical performance requirements including fatigue life, impact properties and material traceability, not addressed by ASME B30.26.
- TURNBUCKLES RECOMMENDED FOR STRAIGHT OR IN-LINE PULL ONLY.
- Modified UNJ thread on end fittings for improved fatigue properties.
- Body has UNC threads.
- Lock Nuts available for all sizes (see page 170).
- Comprehensive end fitting data provided on pages 166 & 167.
- Fatigue Rated.

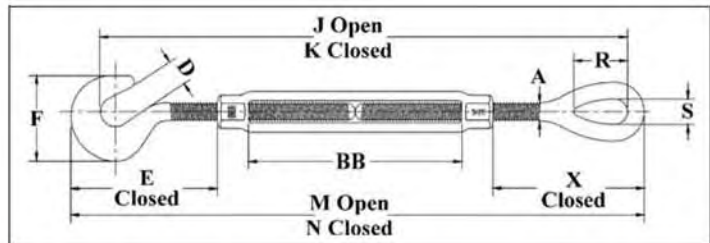

Thread Dia. & Take Up (in.)	HG-225 Stock No.	Working Load Limit (lbs.)*	Weight Each (lbs.)	Dimensions (in.)											
				A	D	E Closed	F	J Open	K Closed	M Open	N Closed	R	S	X Closed	BB
† 1/4 x 4	1030636	400	.31	.25	.44	1.67	1.27	11.66	7.66	12.29	8.29	.81	.34	1.76	4.07
† 5/16 x 4-1/2	1030654	700	.50	.31	.50	2.00	1.50	13.50	9.00	14.28	9.78	.95	.44	2.20	4.58
† 3/8 x 6	1030672	1000	.79	.38	.56	2.28	1.76	17.09	11.09	18.04	12.04	1.13	.53	2.48	6.10
1/2 x 6	1030690	1500	1.80	.50	.65	3.53	2.28	19.57	13.57	20.79	14.79	1.41	.71	3.56	6.03
1/2 x 12	1030734	1500	2.70	.50	.65	3.51	2.28	31.86	19.86	33.08	21.08	1.41	.71	3.54	12.36
5/8 x 6	1030752	2250	2.98	.63	.90	4.24	2.81	21.11	15.11	22.61	16.61	1.80	.88	4.35	6.03
5/8 x 12	1030798	2250	4.35	.63	.90	4.23	2.81	33.45	21.45	34.95	22.95	1.80	.88	4.34	12.39
3/4 x 6	1030814	3000	4.21	.75	.98	5.07	3.33	22.61	16.61	24.45	18.45	2.09	1.00	5.12	6.13
3/4 x 12	1030850	3000	6.52	.75	.98	5.04	3.33	35.01	23.01	36.85	24.85	2.09	1.00	5.09	12.59
3/4 x 18	1030878	3000	8.24	.75	.98	5.07	3.33	47.01	29.01	48.85	30.85	2.09	1.00	5.12	18.53
7/8 x 12	1030896	4000	9.34	.88	1.13	5.82	3.78	36.11	24.11	38.23	26.23	2.38	1.25	5.79	12.16
1 x 12	1030958	5000	13.9	1.00	1.25	6.56	4.25	37.65	25.65	40.06	28.06	3.00	1.43	6.50	12.18

* Proof Load is 2.5 times the Working Load Limit. Ultimate Load is 5 times the Working Load Limit.

† Mechanical Galvanized

Eye & Eye Turnbuckles

HG-226



Meets the performance requirements of Federal Specifications FF-T-791b, Type 1, Form 1 - CLASS 4, and ASTM F-1145, except for those provisions required of the contractor. For additional information, see page 391.

- End fittings are Quenched and Tempered, bodies heat treated by normalizing.
- Hot Dip galvanized steel.
- Turnbuckle eyes are forged elongated, by design, to maximize easy attachment in system and minimize stress in the eye. For turnbuckle sizes 1/4" through 2-1/2", a shackle one size smaller can be reeved through eye.
- Modified UNJ thread on end fittings for improved fatigue properties. Body has UNC threads.
- Crosby products meet or exceed all requirements of ASME B30.26 including identification, ductility, design factor, proof load and temperature requirements. Importantly, Crosby products meet other critical performance requirements including fatigue life, impact properties and material traceability, not addressed by ASME B30.26.
- TURNBUCKLES RECOMMENDED FOR STRAIGHT OR IN-LINE PULL ONLY.
- Lock Nuts available for all sizes (see page 170).
- Comprehensive end fitting data provided on page 167.
- Fatigue Rated.

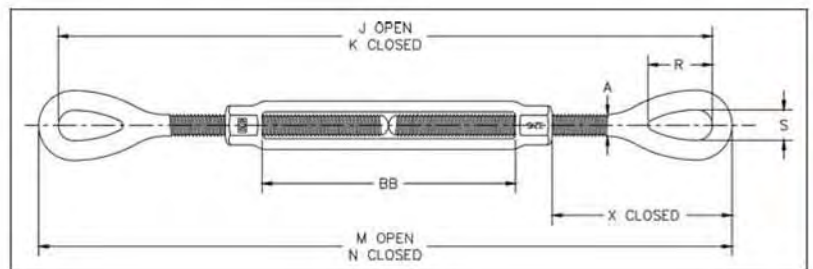

HG-226 Eye & Eye

Thread Dia. & Take Up (in.)	HG-226 Stock No.	Working Load Limit (lbs.)*	Weight Each (lbs.)	Dimensions (in.)								
				A	J Open	K Closed	M Open	N Closed	R	S	X Closed	BB
† 1/4 x 4	1031252	500	.29	.25	11.94	7.94	12.38	8.38	.81	.34	1.76	4.07
† 5/16 x 4-1/2	1031270	800	.48	.31	13.92	9.42	14.48	9.98	.95	.44	2.20	4.58
† 3/8 x 6	1031298	1200	.75	.38	17.56	11.56	18.24	12.24	1.13	.53	2.48	6.10
1/2 x 6	1031314	2200	1.72	.50	19.94	13.94	20.82	14.82	1.41	.71	3.56	6.03
1/2 x 12	1031350	2200	2.63	.50	32.23	20.23	33.11	21.11	1.41	.71	3.54	12.36
5/8 x 6	1031378	3500	2.75	.63	21.72	15.72	22.72	16.72	1.80	.88	4.35	6.03
5/8 x 12	1031412	3500	4.12	.63	34.06	22.06	35.06	23.06	1.80	.88	4.34	12.39
3/4 x 6	1031430	5200	4.22	.75	23.24	17.24	24.50	18.50	2.09	1.00	5.12	6.13
3/4 x 12	1031476	5200	6.12	.75	35.64	23.64	36.90	24.90	2.09	1.00	5.09	12.59
3/4 x 18	1031494	5200	7.83	.75	47.64	29.64	48.90	30.90	2.09	1.00	5.12	18.53
7/8 x 12	1031519	7200	8.83	.88	36.70	24.70	38.20	26.20	2.38	1.25	5.79	12.16
7/8 x 18	1031537	7200	11.5	.88	49.17	31.17	50.67	32.67	2.38	1.25	5.79	18.63
1 x 6	1031555	10000	9.62	1.00	26.24	20.24	28.00	22.00	3.00	1.43	6.50	6.18
1 x 12	1031573	10000	13.0	1.00	38.24	26.24	40.00	28.00	3.00	1.43	6.50	12.18
1 x 18	1031591	10000	16.3	1.00	50.24	32.24	52.00	34.00	3.00	1.43	6.50	18.18
1 x 24	1031617	10000	20.2	1.00	62.84	38.84	64.60	40.60	3.00	1.43	6.47	24.84
1-1/4 x 12	1031635	15200	19.9	1.25	42.14	30.14	44.38	32.38	3.59	1.82	8.49	12.06
1-1/4 x 18	1031653	15200	23.8	1.25	54.14	36.14	56.38	38.38	3.59	1.82	8.49	18.06
1-1/4 x 24	1031671	15200	27.8	1.25	66.70	42.70	68.94	44.94	3.59	1.82	8.49	24.62
1-1/2 x 12	1031699	21400	28.7	1.50	44.24	32.24	46.74	34.74	4.09	2.12	9.46	12.32
1-1/2 x 18	1031715	21400	34.1	1.50	56.24	38.24	58.74	40.74	4.09	2.12	9.46	18.32
1-1/2 x 24	1031733	21400	39.6	1.50	68.86	44.86	71.36	47.36	4.09	2.12	9.46	24.94
1-3/4 x 18	1031779	28000	50.7	1.75	57.38	39.38	60.38	42.38	4.65	2.38	9.97	18.37
1-3/4 x 24	1031797	28000	58.2	1.75	69.38	45.38	72.38	48.38	4.65	2.38	9.97	24.37
2 x 24	1031813	37000	83.5	2.00	75.68	51.68	79.18	55.18	5.81	2.69	13.03	24.48
2-1/2 x 24	1031831	60000	149	2.50	79.18	55.18	83.18	59.18	6.49	3.12	13.76	24.60
2-3/4 x 24	1031859	75000	174	2.75	81.34	57.34	85.84	61.84	7.00	3.25	15.09	24.65

* Proof Load is 2.5 times the Working Load Limit. Ultimate Load is 5 times the Working Load Limit.
†Mechanical Galvanized

開口對眼伸縮器

Jaw & Eye Turnbuckles

HG-227



Meets the performance requirements of Federal Specifications FF-T-791b, Type 1, Form 1 - CLASS 8, and ASTM F-1145, except for those provisions required of the contractor. For additional information, see page 391.

- End fittings are Quenched and Tempered, bodies heat treated by normalizing.
- Hot Dip galvanized steel.
- Turnbuckles eyes are forged and elongated, by design, to maximize easy attachment in system and minimize stress in the eye. For turnbuckles size 1/4" through 2-1/2", a shackle one size smaller can be reeved through eye.
- Forged jaw ends are fitted with bolts and nuts for 1/4" through 5/8", and pins and cotters on 3/4" through 2-3/4" sizes.
- Modified UNJ thread on end fittings for improved fatigue properties.
- Body has UNC threads.
- Crosby products meet or exceed all requirements of ASME B30.26 including identification, ductility, design factor, proof load and temperature requirements. Importantly, Crosby products meet other critical performance requirements including fatigue life, impact properties and material traceability, not addressed by ASME B30.26.
- TURNBUCKLES RECOMMENDED FOR STRAIGHT OR IN-LINE PULL ONLY.
- Lock Nuts available for all sizes (see page 170).
- Comprehensive End fitting data on pages 167 & 168.
- Fatigue Rated.

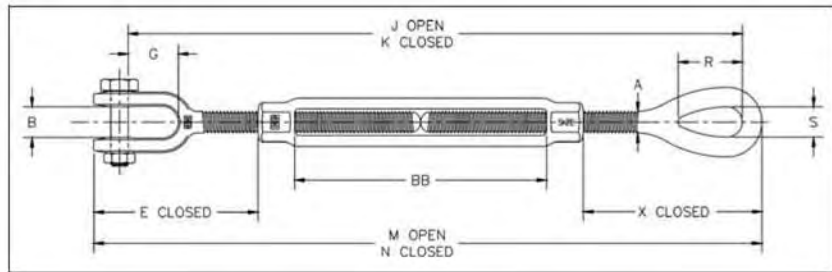

HG-227

Jaw & Eye

Thread Dia. & Take Up (in.)	HG-227 Stock No.	Working Load Limit (lbs.)*	Weight Each (lbs.)	Dimensions (in.)											
				A	B	E Closed	G	J Open	K Closed	M Open	N Closed	R	S	X Closed	BB
† 1/4 x 4	1031877	500	.33	.25	.45	1.66	.64	11.57	7.57	12.28	8.28	.81	.34	1.76	4.07
† 5/16 x 4-1/2	1031895	800	.52	.31	.50	2.02	.87	13.50	9.00	14.30	9.80	.95	.44	2.20	4.58
† 3/8 x 6	1031911	1200	.80	.38	.53	2.11	.85	16.91	10.91	17.87	11.87	1.13	.53	2.48	6.10
1/2 x 6	1031939	2200	1.77	.50	.64	3.22	1.07	19.30	13.30	20.48	14.48	1.41	.71	3.56	6.03
1/2 x 9	1031957	2200	2.25	.50	.64	3.20	1.07	25.59	16.59	26.77	17.77	1.41	.71	3.54	9.36
1/2 x 12	1031975	2200	2.67	.50	.64	3.20	1.07	31.59	19.59	32.77	20.77	1.41	.71	3.54	12.36
5/8 x 6	1031993	3500	2.98	.63	.79	3.90	1.32	20.73	14.73	22.27	16.27	1.80	.88	4.35	6.03
5/8 x 9	1032019	3500	3.72	.63	.79	3.89	1.32	27.07	18.07	28.61	19.61	1.80	.88	4.34	9.39
5/8 x 12	1032037	3500	4.35	.63	.79	3.89	1.32	33.07	21.07	34.61	22.61	1.80	.88	4.34	12.39
3/4 x 6	1032055	5200	4.51	.75	.97	4.71	1.52	22.17	16.17	24.09	18.09	2.09	1.00	5.12	6.13
3/4 x 9	1032073	5200	5.56	.75	.97	4.68	1.52	28.57	19.57	30.49	21.49	2.09	1.00	5.09	9.59
3/4 x 12	1032091	5200	6.42	.75	.97	4.68	1.52	34.57	22.57	36.49	24.49	2.09	1.00	5.09	12.59
3/4 x 18	1032117	5200	8.14	.75	.97	4.71	1.52	46.57	28.57	48.49	30.49	2.09	1.00	5.12	18.53
7/8 x 12	1032135	7200	9.10	.88	1.16	5.50	1.77	35.68	23.68	37.91	25.91	2.38	1.25	5.79	12.16
7/8 x 18	1032153	7200	11.6	.88	1.16	5.50	1.77	48.15	30.15	50.38	32.38	2.38	1.25	5.79	18.63
1 x 6	1032171	10000	10.0	1.00	1.34	6.09	2.05	25.03	19.03	27.59	21.59	3.00	1.43	6.50	6.18
1 x 12	1032199	10000	13.4	1.00	1.34	6.09	2.05	37.03	25.03	39.59	27.59	3.00	1.43	6.50	12.18
1 x 18	1032215	10000	16.7	1.00	1.34	6.09	2.05	49.03	31.03	51.59	33.59	3.00	1.43	6.50	18.18
1 x 24	1032233	10000	20.6	1.00	1.34	6.06	2.05	61.63	37.63	64.19	40.19	3.00	1.43	6.47	24.84
1-1/4 x 12	1032251	15200	20.9	1.25	1.84	8.09	2.82	40.76	28.76	43.98	31.98	3.59	1.82	8.49	12.06
1-1/4 x 18	1032279	15200	24.8	1.25	1.84	8.09	2.82	52.76	34.76	55.98	37.98	3.59	1.82	8.49	18.06
1-1/4 x 24	1032297	15200	28.8	1.25	1.84	8.09	2.82	65.32	41.32	68.54	44.54	3.59	1.82	8.49	24.62
1-1/2 x 12	1032313	21400	30.6	1.50	2.06	8.93	2.81	42.50	30.50	46.21	34.21	4.09	2.12	9.46	12.32
1-1/2 x 18	1032331	21400	36.0	1.50	2.06	8.93	2.81	54.50	36.50	58.21	40.21	4.09	2.12	9.46	18.32
1-1/2 x 24	1032359	21400	41.5	1.50	2.06	8.93	2.81	67.12	43.12	70.83	46.83	4.09	2.12	9.46	24.94
1-3/4 x 18	1032395	28000	52.1	1.75	2.60	9.36	3.35	55.37	37.37	59.77	41.77	4.65	2.38	9.97	18.37
1-3/4 x 24	1032411	28000	59.7	1.75	2.60	9.36	3.35	67.37	43.37	71.77	47.77	4.65	2.38	9.97	24.37
2 x 24	1032439	37000	89.9	2.00	2.62	11.80	3.74	72.66	48.66	77.95	53.95	5.81	2.69	13.03	24.48
2-1/2 x 24	1032457	60000	158	2.50	3.06	13.26	4.44	76.08	52.08	82.68	58.68	6.49	3.12	13.76	24.60
2-3/4 x 24	1032475	75000	187	2.75	3.69	14.92	4.19	78.05	54.05	85.67	61.67	7.00	3.25	15.09	24.65

* Proof Load is 2.5 times the Working Load Limit. Ultimate Load is 5 times the Working Load Limit.

†Mechanical Galvanized

開口對開口伸縮器

Jaw & Jaw Turnbuckles

HG-228



Meets the performance requirements of Federal Specifications FF-T-791b, Type 1, Form 1 - CLASS 7, and ASTM F-1145, except for those provisions required of the contractor. For additional information, see page 391.

- End fittings are Quenched and Tempered, bodies heat treated by normalizing.
- Hot Dip galvanized steel.
- TURNBUCKLES RECOMMENDED FOR STRAIGHT OR IN-LINE PULL ONLY.
- Forged jaw ends are fitted with bolts and nuts for 1/4" through 5/8", and pins and cotters on 3/4" through 2-3/4" sizes.
- Modified UNJ thread on end fittings for improved fatigue properties.
- Body has UNC threads.
- Crosby products meet or exceed all requirements of ASME B30.26 including identification, ductility, design factor, proof load and temperature requirements. Importantly, Crosby products meet other critical performance requirements including fatigue life, impact properties and material traceability, not addressed by ASME B30.26.
- Lock Nuts available for all sizes (see page 170).
- Comprehensive end fitting data provided on page 168.
- Fatigue Rated.

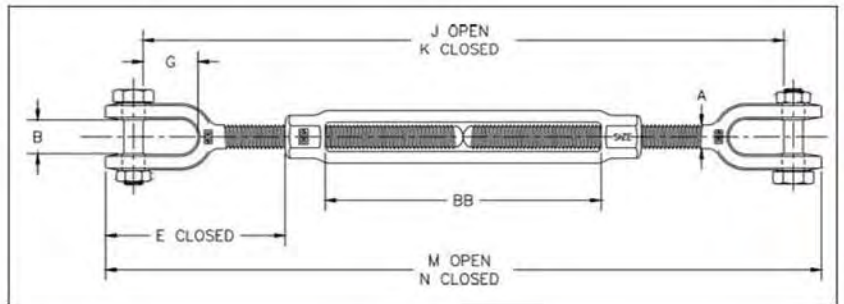

HG-228 Jaw & Jaw

Thread Dia. & Take Up (in.)	HG-228 Stock No.	Working Load Limit (lbs.)*	Weight Each (lbs.)	Dimensions (in.)									
				A	B	E Closed	G	J Open	K Closed	M Open	N Closed	BB	
† 1/4 x 4	1032493	500	.37	.25	.45	1.66	.64	11.19	7.19	12.18	8.18	4.07	
† 5/16 x 4-1/2	1032518	800	.56	.31	.50	2.02	.87	13.07	8.57	14.12	9.62	4.58	
† 3/8 x 6	1032536	1200	.85	.38	.53	2.11	.85	16.25	10.25	17.50	11.50	6.10	
1/2 x 6	1032554	2200	1.82	.50	.64	3.22	1.07	18.65	12.65	20.14	14.14	6.03	
1/2 x 9	1032572	2200	2.29	.50	.64	3.20	1.07	24.94	15.94	26.43	17.43	9.36	
1/2 x 12	1032590	2200	2.71	.50	.64	3.20	1.07	30.94	18.94	32.43	20.43	12.36	
5/8 x 6	1032616	3500	3.21	.63	.79	3.90	1.32	19.74	13.74	21.82	15.82	6.03	
5/8 x 9	1032634	3500	3.95	.63	.79	3.89	1.32	26.08	17.08	28.16	19.16	9.39	
5/8 x 12	1032652	3500	4.58	.63	.79	3.89	1.32	32.08	20.08	34.16	22.16	12.39	
3/4 x 6	1032670	5200	4.80	.75	.97	4.71	1.52	21.09	15.09	23.68	17.68	6.13	
3/4 x 9	1032698	5200	5.85	.75	.97	4.68	1.52	27.49	18.49	30.08	21.08	9.59	
3/4 x 12	1032714	5200	6.72	.75	.97	4.68	1.52	33.49	21.49	36.08	24.08	12.59	
3/4 x 18	1032732	5200	8.45	.75	.97	4.71	1.52	45.49	27.49	48.08	30.08	18.53	
7/8 x 12	1032750	7200	9.37	.88	1.16	5.50	1.77	34.65	22.65	37.62	25.62	12.16	
7/8 x 18	1032778	7200	11.8	.88	1.16	5.50	1.77	47.12	29.12	50.09	32.09	18.63	
1 x 6	1032796	10000	10.4	1.00	1.34	6.09	2.05	23.82	17.82	27.18	21.18	6.18	
1 x 12	1032812	10000	13.8	1.00	1.34	6.09	2.05	35.82	23.82	39.18	27.18	12.18	
1 x 18	1032830	10000	17.1	1.00	1.34	6.09	2.05	47.82	29.82	51.18	33.18	18.18	
1 x 24	1032858	10000	21.0	1.00	1.34	6.06	2.05	60.42	36.42	63.78	39.78	24.84	
1-1/4 x 12	1032876	15200	21.9	1.25	1.84	8.09	2.82	39.37	27.37	43.58	31.58	12.06	
1-1/4 x 18	1032894	15200	25.9	1.25	1.84	8.09	2.82	51.37	33.37	55.58	37.58	18.06	
1-1/4 x 24	1032910	15200	29.8	1.25	1.84	8.09	2.82	63.93	39.93	68.14	44.14	24.62	
1-1/2 x 12	1032938	21400	32.6	1.50	2.06	8.93	2.81	40.76	28.76	45.68	33.68	12.32	
1-1/2 x 18	1032956	21400	38.0	1.50	2.06	8.93	2.81	52.76	34.76	57.68	39.68	18.32	
1-1/2 x 24	1032974	21400	43.5	1.50	2.06	8.93	2.81	65.38	41.38	70.30	46.30	24.94	
1-3/4 x 18	1033018	28000	53.5	1.75	2.60	9.36	3.35	53.35	35.35	59.16	41.16	18.37	
1-3/4 x 24	1033036	28000	61.1	1.75	2.60	9.36	3.35	65.35	41.35	71.16	47.16	24.37	
2 x 24	1033054	37000	96.3	2.00	2.62	11.80	3.74	69.64	45.64	76.72	52.72	24.48	
2-1/2 x 24	1033072	60000	167	2.50	3.06	13.26	4.44	72.97	48.97	82.18	58.18	24.60	
2-3/4 x 24	1033090	75000	199	2.75	3.69	14.92	4.19	74.75	50.75	85.50	61.50	24.65	

* Proof Load is 2.5 times the Working Load Limit. Ultimate Load is 5 times the Working Load Limit.

†Mechanical Galvanized

伸縮器-鈎頭尾端

Turnbuckle - Hook End Fittings

HOOK END FITTINGS

- Quenched and Tempered.
- Hot Dip galvanized steel.
- Hooks are forged with a greater cross sectional area that results in a stronger hook with better fatigue properties.
- Modified UNJ thread for improved fatigue properties.
- Fatigue Rated.

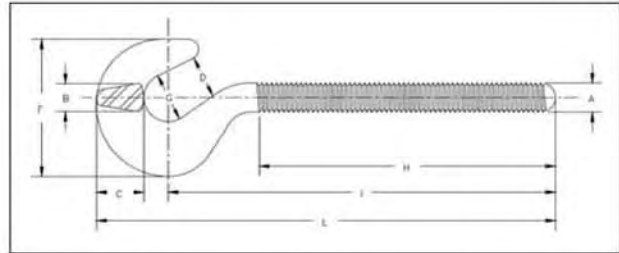

HG-4037 Hook End Fittings

Shank Dia. & Take Up (in.)	RH Hook Stock No.	LH Hook Stock No.	Working Load Limit (lbs.)	Weight Each (lbs.)	Dimensions (in.)								
					A	B	C	D	F	G	H	I	L
1/4 x 4	1070012	1070539	400	.09	.25	.25	.41	.44	1.27	.50	2.59	3.44	4.10
* 5/16 x 4-1/2	1070030	1070557	700	.15	.31	.31	.50	.50	1.50	.56	3.00	4.01	4.79
* 3/8 x 6	1070058	1070575	1000	.27	.38	.38	.61	.56	1.76	.62	3.88	5.00	5.92
1/2 x 6	1070076	1070593	1500	.59	.50	.50	.78	.65	2.28	.82	4.19	6.19	7.38
1/2 x 12	1070110	1070637	1500	.75	.50	.50	.78	.65	2.28	.82	7.19	9.19	10.38
5/8 x 6	1070138	1070655	2250	1.05	.63	.63	1.00	.90	2.81	1.00	4.44	6.75	8.25
5/8 x 12	1070174	1070691	2250	1.31	.63	.63	1.00	.84	2.81	1.00	7.44	9.75	11.25
3/4 x 6	1070192	1070717	3000	1.35	.75	.75	1.21	.98	3.33	1.13	4.56	7.43	9.20
3/4 x 12	1070236	1070753	3000	2.13	.75	.75	1.21	.98	3.33	1.13	7.56	10.43	12.20
3/4 x 18	1070254	1070771	3000	2.51	.75	.75	1.21	.98	3.33	1.13	10.56	13.43	15.20
7/8 x 12	1070272	1070799	4000	3.12	.88	.88	1.37	1.13	3.78	1.26	7.81	11.13	13.13
7/8 x 18	1070290	1070815	4000	3.62	.88	.88	1.37	1.13	3.78	1.26	10.81	14.13	16.13
1 x 6	1070316	1070833	5000	3.96	1.00	1.00	1.53	1.25	4.25	1.38	5.06	8.84	11.06
1 x 12	1070334	1070851	5000	4.72	1.00	1.00	1.53	1.25	4.25	1.38	8.06	11.84	14.06

* Mechanical Galvanized

Turnbuckle - Eye End Fittings

EYE END FITTINGS

- Quenched and Tempered.
- Hot Dip galvanized steel.
- Turnbuckle eyes are forged elongated, by design, to maximize easy attachment in system and minimize stress in the eye. For turnbuckle sizes 1/4" through 2-1/2", a shackle one size smaller can be reeved through eye.
- Modified UNJ thread for improved fatigue properties.
- Fatigue Rated.

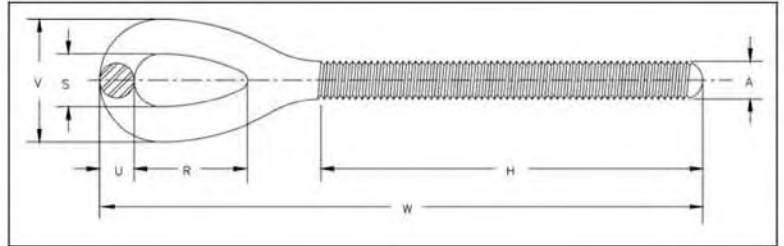

HG-4037 Eye End Fittings

Shank Dia. & Take Up (in.)	RH Eye Stock No.	LH Eye Stock No.	Working Load Limit (lbs.)	Weight Each (lbs.)	Dimensions (in.)						
					A	H	R	S	U	V	W
* 1/4 x 4	1071057	1071672	500	.07	.25	2.59	.81	.34	.22	.78	4.19
* 5/16 x 4 1/2	1071075	1071690	800	.13	.31	3.00	.95	.44	.28	1.00	4.99
* 3/8 x 6	1071093	1071716	1200	.23	.38	3.88	1.13	.53	.34	1.21	6.12
1/2 x 6	1071119	1071734	2200	.51	.50	4.19	1.41	.71	.44	1.59	7.41
1/2 x 9	1071137	1071752	2200	.59	.50	5.69	1.41	.71	.44	1.59	8.91
1/2 x 12	1071155	1071770	2200	.68	.50	7.19	1.41	.71	.44	1.59	10.41
5/8 x 6	1071173	1071798	3500	.82	.63	4.44	1.80	.88	.50	1.88	8.36
5/8 x 9	1071191	1071814	3500	.95	.63	5.94	1.80	.88	.50	1.88	9.86
5/8 x 12	1071217	1071832	3500	1.08	.63	7.44	1.80	.88	.50	1.88	11.36
3/4 x 6	1071235	1071850	5200	1.36	.75	4.56	2.09	1.00	.63	2.26	9.25
3/4 x 9	1071253	1071878	5200	1.55	.75	6.06	2.09	1.00	.63	2.26	10.75
3/4 x 12	1071271	1071896	5200	1.73	.75	7.56	2.09	1.00	.63	2.26	12.25
3/4 x 18	1071299	1071912	5200	2.10	.75	10.56	2.09	1.00	.63	2.26	15.25
7/8 x 12	1071315	1071930	7200	2.61	.88	7.81	2.38	1.25	.75	2.75	13.10
7/8 x 18	1071333	1071958	7200	3.12	.88	10.81	2.38	1.25	.75	2.75	16.10
1 x 6	1071351	1071976	10000	3.15	1.00	5.06	3.00	1.43	.88	3.19	11.00
1 x 12	1071379	1071994	10000	3.81	1.00	8.06	3.00	1.43	.88	3.19	14.00
1 x 18	1071397	1072010	10000	4.48	1.00	11.06	3.00	1.43	.88	3.19	17.00
1 x 24	1071413	1072038	10000	5.15	1.00	14.06	3.00	1.43	.88	3.19	20.00
1-1/4 x 12	1071431	1072056	15200	7.07	1.25	8.38	3.59	1.82	1.12	4.06	16.19
1-1/4 x 18	1071459	1072074	15200	8.12	1.25	11.38	3.59	1.82	1.12	4.06	19.19
1-1/4 x 24	1071477	1072092	15200	9.16	1.25	14.38	3.59	1.82	1.12	4.06	22.19
1-1/2 x 12	1071495	1072118	21400	10.3	1.50	8.75	4.09	2.12	1.25	4.62	17.37
1-1/2 x 18	1071510	1072136	21400	11.8	1.50	11.75	4.09	2.12	1.25	4.62	20.37
1-1/2 x 24	1071538	1072154	21400	13.3	1.50	14.75	4.09	2.12	1.25	4.62	23.37
1-3/4 x 18	1071574	1072190	28000	17.5	1.75	12.16	4.65	2.38	1.50	5.38	21.19
1-3/4 x 24	1071592	1072216	28000	19.5	1.75	15.16	4.65	2.38	1.50	5.38	24.19
2 x 24	1071618	1072234	37000	28.9	2.00	15.59	5.81	2.69	1.75	6.19	27.59
2-1/2 x 24	1071636	1072252	60000	46.4	2.50	17.56	6.50	3.12	2.00	7.12	29.59
2-3/4 x 24	1071654	1072270	75000	60.2	2.75	17.69	7.00	3.25	2.25	7.75	30.92

* Mechanical Galvanized

Turnbuckle - Jaw End Fittings

JAW END FITTINGS

- Quenched and Tempered.
- Hot dip galvanized steel.
- Forged jaw ends are fitted with bolts and nuts on sizes 1/4" through 5/8", and pins and cotters on sizes 3/4" through 2-3/4".
- Modified UNJ thread for improved fatigue properties.
- Fatigue Rated.

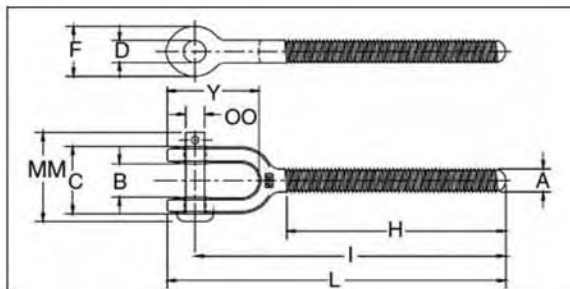

HG-4037 Jaw End Fittings

Shank Dia. & Take Up (in.)	RH Jaw Stock No.	LH Jaw Stock No.	Working Load Limit (lbs.)	Weight Each (lbs.)	Dimensions (in.)											
					A	B	C	D	F	H	I Nom. Min.	L Nom. Min.	Y	MM	OO Bolt Pin	
* 1/4 x 4	1072298	1072911	500	.11	.25	.45	.91	.30	.63	.63	2.59	3.72	4.09	1.13	1.41	.25
* 5/16 x 4 1/2	1072314	1072939	800	.17	.31	.50	1.02	.30	.69	.69	3.00	4.41	4.81	1.39	1.41	.25
* 3/8 x 6	1072332	1072957	1200	.28	.38	.53	1.15	.36	.81	.81	3.88	5.28	5.75	1.47	1.58	.31
1/2 x 6	1072350	1072975	2200	.56	.50	.64	1.36	.42	1.00	1.00	4.19	6.51	7.07	1.81	1.87	.37
1/2 x 9	1072378	1072993	2200	.63	.50	.64	1.36	.42	1.00	1.00	5.69	8.01	8.57	1.81	1.87	.37
1/2 x 12	1072396	1073019	2200	.72	.50	.64	1.36	.42	1.00	1.00	7.19	9.51	10.07	1.81	1.87	.37
5/8 x 6	1072412	1073037	3500	1.05	.63	.79	1.75	.55	1.31	1.31	4.31	7.12	7.91	2.36	2.44	.50
5/8 x 9	1072430	1073055	3500	1.18	.63	.79	1.75	.55	1.31	1.31	5.81	8.62	9.41	2.36	2.44	.50
5/8 x 12	1072458	1073073	3500	1.31	.63	.79	1.75	.55	1.31	1.31	7.31	10.12	10.91	2.36	2.44	.50
3/4 x 6	1072476	1073091	5200	1.65	.75	.97	2.09	.69	1.63	1.63	4.56	7.86	8.84	2.81	2.56	.63
3/4 x 9	1072494	1073117	5200	1.84	.75	.97	2.09	.69	1.63	1.63	6.06	9.36	10.34	2.81	2.56	.63
3/4 x 12	1072519	1073135	5200	2.03	.75	.97	2.09	.69	1.63	1.63	7.56	10.86	11.84	2.81	2.56	.63
3/4 x 18	1072537	1073153	5200	2.41	.75	.97	2.09	.69	1.63	1.63	10.56	13.86	14.84	2.81	2.56	.63
7/8 x 12	1072555	1073171	7200	2.88	.88	1.16	2.56	.81	1.88	1.88	7.81	11.70	12.81	3.25	3.09	.75
7/8 x 18	1072573	1073199	7200	3.25	.88	1.16	2.56	.81	1.88	1.88	10.81	14.70	15.81	3.25	3.09	.75
1 x 6	1072591	1073215	10000	3.56	1.00	1.34	2.76	.94	2.12	2.12	5.06	9.35	10.59	3.73	3.44	.88
1 x 12	1072617	1073233	10000	4.22	1.00	1.34	2.76	.94	2.12	2.12	8.06	12.35	13.59	3.73	3.44	.88
1 x 18	1072635	1073251	10000	4.89	1.00	1.34	2.76	.94	2.12	2.12	11.06	15.35	16.59	3.73	3.44	.88
1 x 24	1072653	1073279	10000	5.56	1.00	1.34	2.76	.94	2.12	2.12	14.06	18.35	19.59	3.73	3.44	.88
1-1/4 x 12	1072671	1073297	15200	8.10	1.25	1.84	3.72	1.19	2.63	2.63	8.38	14.25	15.79	4.92	4.53	1.13
1-1/4 x 18	1072699	1073313	15200	9.14	1.25	1.84	3.72	1.19	2.63	2.63	11.38	17.25	18.79	4.92	4.53	1.13
1-1/4 x 24	1072715	1073331	15200	10.2	1.25	1.84	3.72	1.19	2.63	2.63	14.38	20.25	21.79	4.92	4.53	1.13
1-1/2 x 12	1072733	1073359	21400	12.3	1.50	2.06	4.16	1.47	3.12	3.12	8.75	15.07	16.84	5.27	5.13	1.38
1-1/2 x 18	1072751	1073377	21400	13.8	1.50	2.06	4.16	1.47	3.12	3.12	11.75	18.07	19.84	5.27	5.13	1.38
1-1/2 x 24	1072779	1073395	21400	15.3	1.50	2.06	4.16	1.47	3.12	3.12	14.75	21.07	22.84	5.27	5.13	1.38
1-3/4 x 18	1072813	1073439	28000	18.9	1.75	2.60	4.66	1.72	3.50	3.50	12.16	18.49	20.58	6.25	6.00	1.63
1-3/4 x 24	1072831	1073457	28000	21.0	1.75	2.60	4.66	1.72	3.50	3.50	15.16	21.49	23.58	6.25	6.00	1.63
2 x 24	1072859	1073475	37000	35.3	2.00	2.62	5.61	2.09	4.19	4.19	15.59	23.82	26.36	7.28	6.88	2.00
2-1/2 x 24	1072877	1073493	60000	55.8	2.50	3.06	5.84	2.38	5.62	5.62	17.20	25.61	29.09	9.04	7.50	2.25
2-3/4 x 24	1072895	1073518	75000	72.4	2.75	3.69	6.57	2.88	6.12	6.12	17.35	26.75	30.75	9.56	8.38	2.75

* Mechanical Galvanized

Turnbuckles - Body Only

HG-2510 BODY

- Heat treat by normalizing.
- Hot Dip galvanized.
- UNC threads
- Fatigue Rated.
- Meets the performance requirements of Federal Specifications FF-T-791b, Type 1, Form 1 - Class 2, except for those provisions required by the contractor.

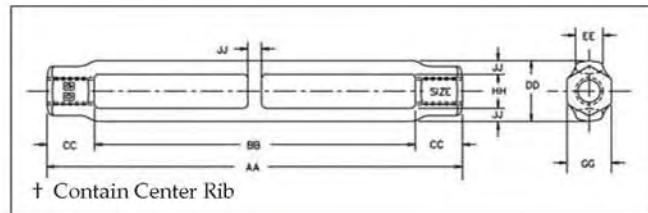
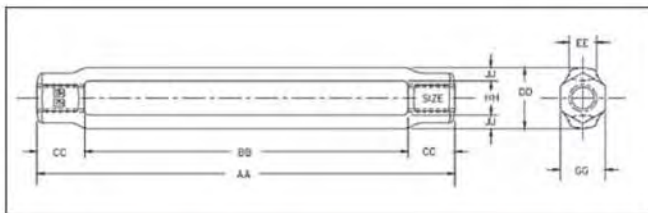

Shank Dia. & Take Up (in.)	HG-2510 Stock No.	Working Load Limit (lbs.)	Weight Each (lbs.)	Dimensions (in.)							
				AA	BB	CC	DD	EE	GG	HH	JJ
* 1/4 x 4	1033893	500	.15	4.87	4.07	.40	.72	.34	.50	.38	.17
* 5/16 x 4-1/2	1033919	800	.22	5.59	4.58	.51	.82	.38	.56	.44	.19
* 3/8 x 6	1033937	1200	.29	7.29	6.10	.60	.88	.38	.63	.50	.19
1/2 x 6	1033955	2200	.70	7.70	6.03	.84	1.19	.68	.81	.63	.28
† 1/2 x 9	1033973	2200	1.03	11.03	9.36	.84	1.19	.68	.81	.63	.28
† 1/2 x 12	1033991	2200	1.27	14.03	12.36	.84	1.19	.68	.81	.63	.28
5/8 x 6	1034017	3500	1.11	8.02	6.03	1.00	1.43	.83	1.00	.75	.34
† 5/8 x 9	1034035	3500	1.59	11.38	9.39	1.00	1.43	.83	1.00	.75	.34
† 5/8 x 12	1034053	3500	1.96	14.38	12.39	1.00	1.43	.83	1.00	.75	.34
3/4 x 6	1034071	5200	1.50	8.26	6.13	1.07	1.74	.94	1.13	.94	.40
† 3/4 x 9	1034099	5200	2.17	11.72	9.59	1.07	1.74	.94	1.13	.94	.40
† 3/4 x 12	1034115	5200	2.66	14.72	12.59	1.07	1.74	.94	1.13	.94	.40
† 3/4 x 18	1034133	5200	3.63	20.66	18.53	1.07	1.74	.94	1.13	.94	.40
7/8 x 12	1034179	7200	3.61	14.62	12.16	1.23	2.00	1.13	1.31	1.06	.47
† 7/8 x 18	1034197	7200	5.27	21.09	18.63	1.23	2.00	1.13	1.31	1.06	.47
1 x 6	1034213	10000	3.32	9.00	6.18	1.41	2.45	1.25	1.50	1.25	.60
1 x 12	1034231	10000	5.34	15.00	12.18	1.41	2.45	1.25	1.50	1.25	.60
1 x 18	1034259	10000	7.35	21.00	18.18	1.41	2.45	1.25	1.50	1.25	.60
† 1 x 24	1034277	10000	9.85	27.66	24.84	1.41	2.45	1.25	1.50	1.25	.60
1-1/4 x 12	1034339	15200	5.72	15.40	12.06	1.67	2.62	1.25	1.88	1.50	.56
1-1/4 x 18	1034357	15200	7.58	21.40	18.06	1.67	2.62	1.25	1.88	1.50	.56
† 1-1/4 x 24	1034375	15200	9.45	27.96	24.62	1.67	2.62	1.25	1.88	1.50	.56
1-1/2 x 12	1034437	21400	8.01	15.82	12.32	1.75	2.99	1.50	2.25	1.75	.62
1-1/2 x 18	1034455	21400	10.4	21.82	18.32	1.75	2.99	1.50	2.25	1.75	.62
† 1-1/2 x 24	1034473	21400	12.9	28.45	24.94	1.75	2.99	1.50	2.25	1.75	.62
1-3/4 x 18	1034552	28000	15.7	22.44	18.37	2.04	3.62	1.75	2.62	2.12	.75
1-3/4 x 24	1034570	28000	19.2	28.44	24.37	2.04	3.62	1.75	2.62	2.12	.75
2 x 24	1034632	37000	25.8	29.13	24.48	2.33	4.14	2.00	3.00	2.38	.88
2-1/2 x 24	1034678	60000	55.9	31.66	24.60	3.53	5.62	2.75	3.88	3.12	1.25
2-3/4 x 24	1034696	75000	54.0	31.66	24.65	3.51	5.62	2.75	3.88	4.48	1.25

* Mechanical Galvanized

† Contains Center Rib for additional body support.

Rigging Accessories

伸縮器-螺牙端

Stub End Turnbuckles

HS-251



- End fittings are Quenched and Tempered, bodies heat treated by normalizing.
- Complete assembly is self - colored.
- Reference American Welding Society Specifications for proper welding procedures.
- Meets the performance requirements of Federal Specifications FF-T-791b, Type 1 Form 1 - CLASS 3, and ASTM F-1145, except for those provisions required of the contractor.

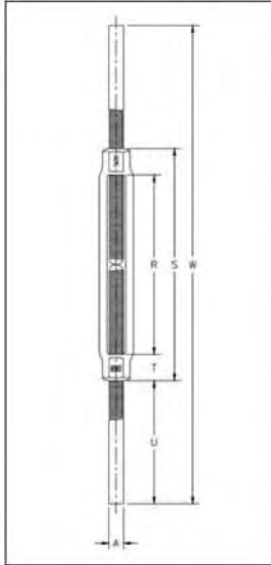

HS-251 Stub End Turnbuckles

Shank Dia. & Take up (in.)	HS-251 Stock No.	Working Load Limit (lbs.)	Weight Each (lbs.)	Dimensions (in.)					
				A	R	S	T	U	W
3/8 x 6	1033143	1200	.75	.38	6.00	7.13	.56	4.44	16.00
1/2 x 6	1033161	2200	1.25	.50	6.00	7.50	.75	4.25	16.00
5/8 x 6	1033223	3500	2.11	.63	6.00	7.88	.94	4.06	16.00
3/4 x 6	1033287	5200	3.27	.75	6.00	8.25	1.13	4.38	17.00
7/8 x 6	1033367	7200	4.78	.88	6.00	8.63	1.31	4.69	18.00
1 x 6	1033429	10000	6.36	1.00	6.00	9.00	1.50	5.00	19.00
1 x 12	1033447	10000	8.80	1.00	12.00	15.00	1.50	5.00	25.00
1-1/8 x 6	1033508	12400	8.88	1.13	6.00	9.13	1.56	4.94	19.00
1-1/4 x 6	1033526	15200	10.18	1.25	6.00	9.13	1.56	5.44	20.00
1-1/4 x 12	1033544	15200	13.60	1.25	12.00	15.12	1.56	5.44	26.00
1-1/2 x 12	1033642	21400	20.44	1.50	12.00	15.75	1.88	5.38	26.50

LOCK NUTS

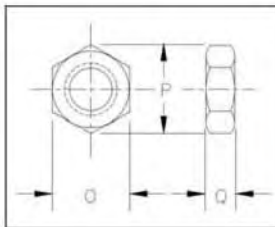

HG-4060 / HG-4061 Lock Nuts

Thread Diameter (in.)	Right Hand HG-4060 Stock No.	Left Hand HG-4061 Stock No.	Weight Per 100 (lbs.)	Dimensions (in.)		
				O	P	Q
1/4	1075115	1075491	.80	.44	.50	.16
5/16	1075133	1075516	1.30	.50	.56	.19
3/8	1075151	1075534	2.00	.56	.64	.22
1/2	1075197	1075570	4.00	.75	.86	.31
5/8	1075213	1075598	7.00	.94	1.06	.38
3/4	1075231	1075614	11.00	1.13	1.26	.42
7/8	1075259	1075632	16.30	1.31	1.50	.48
1	1075277	1075650	23.80	1.50	1.69	.55
1-1/8	1075295	1075678	32.00	1.50	1.69	.55
1-1/4	1075311	1075696	62.50	1.88	2.13	.72
1-1/2	1075357	1075730	72.00	2.25	2.53	.84
1-3/4	1075393	1075776	112.00	2.75	3.18	1.00
2	1075419	1075794	150.00	3.12	3.61	1.12
2-1/2	1075455	1075838	330.00	3.88	4.47	1.50
2-3/4	1075473	1075856	425.00	4.25	4.91	1.62